

# Panasonic

Premium Design Phone  
with Smartphone Connect  
**KX-PRW110**



## S h a p i n g   C o n v e r s a t i o n

Premium designs for a stylish you

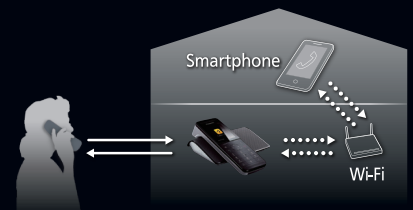

**Smartphone Connect Model**

## Sophisticated Design

This phone incorporates real metal to provide a sophisticated finish with a comfortable grip.

It was created following the concepts of universal design. Its lay down style makes it easy to pick up, operate, and dial with only one hand.



## Beautiful Graphic User Interface

This phone uses an easy to read, beautiful new graphical interface, stunningly realized on its 2.2-inch TFT colour LCD (QVGA) screen.

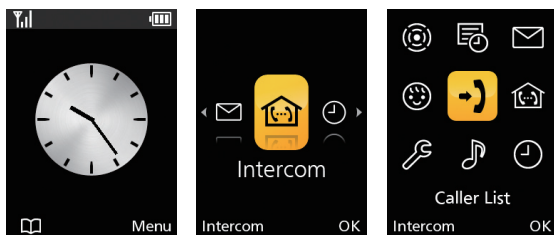

## Other Features

- Noise Reduction
- Key Finder Compatible\*<sup>1</sup>
- Baby Monitor
- Caller ID\*<sup>2</sup> / Talking Caller ID\*<sup>2\*3</sup>
- Incoming Call Barring (100 numbers)\*<sup>2</sup>
- 3 Numbers per Name in the Phonebook (Up to 500 number entries, Shared Phonebook)
- SMS Compatible\*<sup>2\*4</sup>
- One Touch Eco Mode

\*<sup>1</sup> The optional Key Finder KX-TGA20 is required. Up to 4 Key Finders can be used.

\*<sup>2</sup> Requires subscription to a Caller ID and / or SMS service offered by your telephone company.

\*<sup>3</sup> KX-PRW110G Only.

\*<sup>4</sup> Except KX-PRW110JT / KX-PRW110TR.

## Optional Accessories

Optional Handset  
**KX-PRWA10**



Key Finder  
**KX-TGA20**



### Trademarks and registered trademarks

- Android is a trademark of Google Inc.
- iPhone and iPad are trademarks of Apple Inc.
- Wi-Fi® is a registered mark of the Wi-Fi Alliance.

### Important

- Safety Precaution: carefully read the operating instructions and installation manual before using this product.

## Smartphone Connect\*

You can use your smartphone as an additional DECT handset.



### ● Answer Landline Calls with Your Smartphone

You can set your smartphone to receive calls from this phone, so that you don't have to bother getting up when relaxing in bed, in the living room, etc.

### ● Make Landline Calls with Your Smartphone

You can make landline calls using the phonebook in your smartphone, without having to copy it to the DECT handset. Names and groupings from your phonebook can be used, making it easy to find your contacts.

### ● Transfer Landline Calls between Your Smartphone and Your DECT Handsets

You can transfer calls received on the DECT handset in your living room to your child's smartphone in his or her room, etc.

### And more features:

- Use as an intercom between smartphones and handsets
- Make 3 party conference calls (outside caller - DECT handset - smartphone)
- Copy ringtone and wallpaper images from smartphones (Android™ only)

\* Requires wireless router for Wi-Fi® connections.

Requires the Smartphone Connect app to be installed on each smartphone in order to function.

## Specifications

Multiple Handsets Capability:	Up to 6 Handsets
LCD Language:	14 or 16 Languages*
Smartphone connect	
Multiple Smartphones Capability:	Up to 4 Smartphones
Supported devices:	iPhone 4, iPhone 4S, iPhone 5, iPad, or iPad mini (iOS 5.0 or later) or An Android device (Android 4.0 or later)
Talk Time:	Up to 11 hours
Standby Time:	Up to 150 hours
Standby Power Consumption:	2.0 W
Dimensions (W x D x H)	
Base Unit:	116 mm × 92 mm × 31 mm
Handset:	47 mm × 35 mm × 153 mm
Charger (Optional Handset):	71 mm × 92 mm × 29 mm
Weight	
Base Unit:	150 g
Handset:	140 g
Charger (Optional Handset):	140 g

\* **14 Languages:** KX-PRW110G / KX-PRW110FR / KX-PRW110GR / KX-PRW110JT / KX-PRW110NE / KX-PRW110NL / KX-PRW110SL / KX-PRW110SP / KX-PRW110TR only  
English, German, Spanish, Norwegian, French, Italian, Danish, Dutch, Swedish, Finnish, Greek, Turkish, Portuguese, Catalan

**16 Languages:** KX-PRW110FX / KX-PRW110PD only  
English, German, Polish, Czech, Slovak, Hungarian, Croatian, Slovene, Estonian, Lithuanian, Latvian, Rumanian, Bulgarian, Serbian, Albanian, Macedonian

- The actual product may vary slightly from photograph.
- All pictures of LCD display and LED lamp are simulated.
- Weights and dimensions are approximate.
- Design and Specifications are subject to change without notice.
- These products may be subject to export control regulations.

DISTRIBUTED BY :

# Panasonic